

# ROTOMAC™

## “DP” SERIES PROGRESSIVE CAVITY PUMPS

Versatile/ Reliable/ Robust/ Quiet/ Self Priming/ Compact/ Easily Maintained

### APPLICATIONS

#### Industrial:

Diesel, Chemical Dosing, Heating  
Oil, Vegetable Oils, Water Based  
Inks, Plating Solution, Non  
Aggressive Chemicals, Food  
Products & Winery.

#### Domestic:

Cellar Drainage, Septic Tank/  
Cess Pit Emptying, Sprinkler  
System/ Irrigation, Cleaning of  
Cattle and Cattle Sheds, Dirty  
Water Transfer, Sampling from  
Wells/ Rivers/ Streams,  
Packaged Grey Water Systems.



## ROTOMAC™ Pumps - World Class Quality.

### Performance Value

“DP” Series Progressive Cavity Pumps can virtually handle any media from water - like, non - lubricating, abrasive, viscous or corrosive in nature. There are no valves required and the pump cannot vapor or airlock.

The flow is linear, non- pulsating and steady even with change in suction head. Due to the low internal velocity of the pumping media, the shearing action and degradation of the shear sensitive media is minimal.

# ROTOMAC™

## 'DP' Series Progressive Cavity Pumps

### PUMP CODING

Feature	Description	Basic Pump Coding									
Type	DP	DP									
Design	C, B	C									
Size	12, 14, 16, 20, 26, 28		26								
Body Matl	Cl, SS, ST			ST							
Stator	P, E, H, V				P						
Volt	230, 415					230					
Hz	50, 60						50				
Ph	1, 3								1		
Protection	IP22, 54, 55										55

### Material of Construction

**Body Material :** CI - Cast Iron

SS - CF8

ST - CF8M

**Stator Polymer :** P - High Nitrile

E - EPDM

H - Hypalon

V - Viton

**Rotating Parts :** AISI 316

**Shaft Sealing :** Single Mechanical Seal  
(Carbon Vs Ceramic)

1975



2010

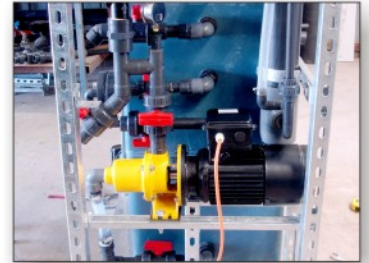

Note : Unshaded Portion not applicable for DPB

### Close Coupled "DPC" Series Performance Details

Pump Type & Size	Port Size (BSP)	Power (Frame) (KW)	SPEED (RPM)	Suction Lift Max. (M)	Flow Rates (LPH)						
					Total Head From All Causes (M)						
					5	10	15	20	25	30	35
DPC12CIP	3/4"	0.12 (63)	1440	7.5	350	320	295	275	250	230	200
DPC14CIP	3/4"	0.12 (63)	1440	7.5	430	410	390	350	310	280	240
DPC16CIP	3/4"	0.12 (63)	1440	7.5	570	540	510	480	435	410	390
DPC20CIP	1"	0.18 (71)	1440	7.5	730	694	654	612	564	510	450
DPC26CIP	1"	0.37 (80)	1440	7.5	1660	1580	1500	1400	1300	1180	1058
DPC28CIP	1"	0.55 (80)	1440	7.5	3526	3373	3206	3017	2792	2520	2200

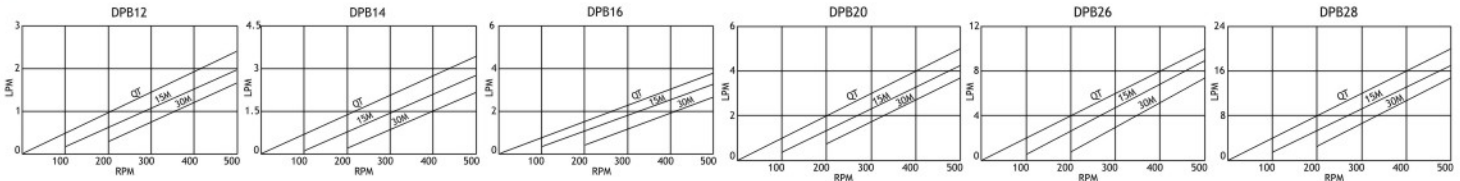

### Basic Dimensions (mm)

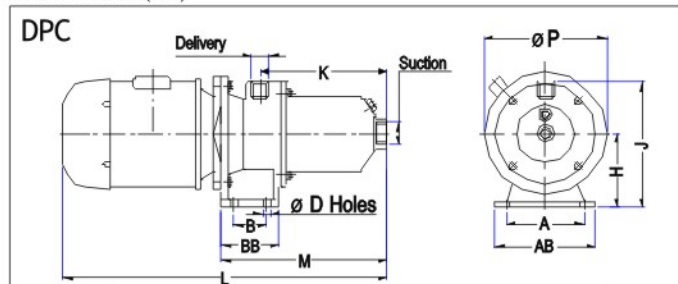

PUMP SIZE	DIMENSIONS											Suction & Delivery	Weight (Kg.) Steel
	A	B	AB	BB	D	H	J	K	M	L	P		
DPC - 12	100	30	120	74	10	80	141	121	182	367	140	3/4" BSP	10.0
DPC - 14	100	30	120	74	10	80	141	121	182	367	140	3/4" BSP	10.5
DPC - 16	100	30	120	74	10	80	141	121	182	367	140	3/4" BSP	11.0
DPC - 20	120	24	140	66	10	90	157	137	198	406	160	1" BSP	14.0
DPC - 26	160	24	180	66	10	110	177	164	225	476	200	1" BSP	22.0
DPC - 28	160	24	180	66	10	110	177	164	225	476	200	1" BSP	23.0

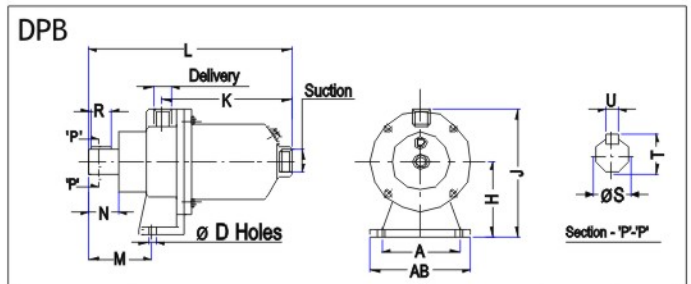

PUMP SIZE	DIMENSIONS											Suction & Delivery	Weight (Kg.) Steel	
	A	AB	D	H	J	K	L	M	N	S	T			U
DPB - 12	104	130	10	80	155	128	242	104	42	18	21	6	3/4" BSP	3.5
DPB - 14	104	130	10	80	155	128	242	104	42	18	21	6	3/4" BSP	4.0
DPB - 16	104	130	10	80	155	128	242	104	42	18	21	6	3/4" BSP	4.0
DPB - 20	104	130	10	80	155	144	258	104	42	18	21	6	1" BSP	4.5
DPB - 26	104	130	10	80	155	171	285	104	42	18	21	6	1" BSP	6.5
DPB - 28	104	130	10	80	155	171	285	104	42	18	21	6	1" BSP	7.5

Due to continuous development process, the dimensions shown here may differ from actual. Contact factory for certified drawings. Right of technical changes reserved.

# ROTOMAC™

**ROTOMAC INDUSTRIES PVT. LTD.**

D-4A, PANKI INDUSTRIAL AREA, SITE-1,

KANPUR - 208 022 (U.P.) INDIA

Tel: 2691704, 2691705; Fax: +91 (0512) 2691706

email: [rotomac@vsnl.net](mailto:rotomac@vsnl.net); [marketing@rotomacpump.org](mailto:marketing@rotomacpump.org)

Web: [www.rotomacpump.com](http://www.rotomacpump.com)



An ISO 9001:2008 Certified Company